

BIMETALLIC JOINTS - STRAIGHT TYPE



MATERIAL : ELECTROLYTIC GRADE AL 99.5 AND COPPER

FINISH : BRIGHT

FEATURES : BARREL PREFILLED WITH OXIDE INHIBITING COMPOUND AND CAPPED

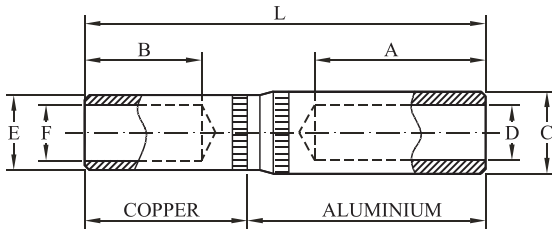

CABLE SIZE (AL)mm ²	CABLE SIZE (CU)mm ²	DIMENSIONS IN mm							PER BOX	E - CODE
		A	B	C	D	E	F	L		
25	25	32	21.5	12	7	9.7	7	70	25	ABMCS25
35	35	32	21.5	12	8.5	11.5	8.4	70	20	ABMCS35
50	50	32	21.5	16	9.5	12.7	9.5	70	20	ABMCS50
70	70	32	21.5	16	11	14.3	11.1	70	20	ABMCS70
95	95	60	40	21.5	13	17.5	13.5	120	15	ABMCS95
120	120	60	40	21.5	15	20.6	15.5	120	15	ABMCS120
150	150	60	40	27	16.5	22.2	16.3	120	15	ABMCS150
185	185	60	40	27	18.5	24.3	18.3	120	15	ABMCS185
240	240	60	40	35	21	28.6	21.2	122	10	ABMCS240
300	300	60	40	35	23.5	31.9	23.8	125	10	ABMCS300
400	400	70	55	47	26.5	34.9	26.8	153	5	ABMCS400
500	500	70	58	47	29.5	38	30	155	5	ABMCS500
630	630	70	60	54	33.5	45	33.5	160	2	ABMCS630

BIMETALLIC JOINTS - REDUCING TYPE

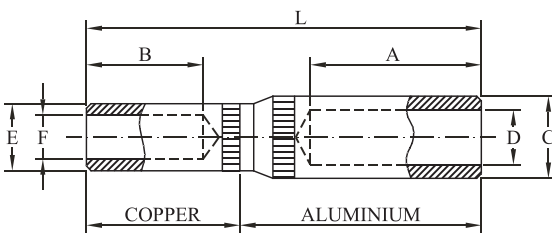

CABLE SIZE (AL)mm ²	CABLE SIZE (CU)mm ²	DIMENSIONS IN mm							PER BOX	E - CODE
		L	A	B	C	D	E	F		
35	25	70	32	21.5	12	8.5	9.7	7	25	ABMC3525
50	35	70	32	21.5	16	9.5	11.5	8.4	20	ABMC5035
70	50	70	32	21.5	16	11	12.7	9.5	20	ABMC7050
95	70	70	60	40	21.5	13	14.3	11.1	15	ABMC9570
120	70	120	60	40	21.5	15	14.3	11.5	15	ABMC1270
120	95	120	60	40	21.5	15	17.5	13.5	15	ABMC1295
150	120	120	60	40	27	16.5	20.6	15.5	15	ABMC1512
185	70	120	60	40	27	18.5	14.3	11.5	15	ABMC1870
185	150	120	60	40	27	18.5	22.2	16.3	15	ABMC1815
240	100	122	60	40	35	21	17.5	13.5	10	ABMC2410
240	185	122	60	40	35	21	24.3	18.3	10	ABMC2418
300	185	125	60	40	35	23.5	24.3	18.5	10	ABMC3018
300	240	125	60	40	35	23.5	28.6	21.2	10	ABMC3024
400	170	153	70	55	47	28.5	24.3	18.3	5	ABMC4017
400	300	153	70	55	47	26.5	31.9	23.8	5	ABMC4030
500	400	155	70	58	47	29.5	34.9	26.8	5	ABMC5040
630	500	160	70	60	54	33.5	38	30	2	ABMC6350